



Preliminary Data



TSCT 1104
Titanium Supreme Coppersleeve Tweeter
Ø 110 mm, 4Ω

SPECIFICATIONS

General Data

| | | |
|------------------------------|------------|---------------------------|
| Overall Dimensions | DxH | 110mm x 39mm(4" x 1.33") |
| Nominal Power Handling (DIN) | P | 200 Watt |
| Transient Power 10ms | | |
| Sensitivity 2.83V/1M | | 95 dB SPL |
| Frequency Response | | See graph |
| Dome Material | | Acuflex™ coated silk dome |
| Net Weight | Kg | 0.5 |

Electrical Data

| | | |
|------------------------------|------------|---------|
| Nominal Impedance | Z | 4Ω |
| DC Resistance | Re | 4.19Ω |
| Voice Coil Inductance @ 1KHz | LBM | 0.047mH |

Voice Coil and Magnet Parameters

| | | |
|------------------------|------------|-------------------------|
| Voice Coil Diameter | DIA | 28mm |
| Voice Coil Height | | 2mm |
| HE Magnetic Gap Height | HE | 4mm |
| Max. Linear Excursion | X | ± 1mm |
| Voice Coil Former | | Titanium |
| Voice Coil Wire | | Hexatech™ 100% Aluminum |
| Number Of Layers | | 2 |
| Magnet System Type | | Neodymium Vented |
| B Flux Density | B | |
| BL Product | BXL | |

T-S Parameters

| | Small Signal | 1 volts |
|---------------------------|---------------------|----------------------|
| Suspension Compliance | Cms | |
| Mechanical Q Factor | Qms | 2.41 |
| Electrical Q Factor | Qes | 0.53 |
| Total Q Factor | Qts | 0.43 |
| Mechanical Resistance | Rms | 3.37 ΩM |
| Moving Mass | Mms | |
| Eq. Cas Air Load (liters) | VAS | |
| Resonant Frequency | Fs | 591 Hz 573 Hz |
| Effective Piston Area | SD | 6.00 cm ² |

FEATURES

- ▶ Underhung voice coil
- ▶ 2.1" Large Hexatech™ Aluminum voice coil
- ▶ Neodymium flat pancake magnet
- ▶ High power handling
- ▶ 110 mm IDR™ Improved Dispersion Recess
- ▶ Titanium VC Former
- ▶ Replaceable Acuflex™ dome/coil assembly
- ▶ Aluminum die-cast rear chamber

UNIT DIMENSIONS

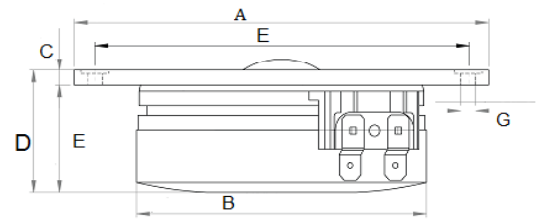

| | |
|--|----------|
| A - Overall diameter | 110mm |
| B - Cut out diameter | 72.8mm |
| C - Flange thickness | 4.2mm |
| D - Overall height | 33.8mm |
| E - Basket depth | 29.6mm |
| F - Mounting holes location diameter | 94mm |
| G - 6 Mounting holes, at 60° interval, inner hole diameter | Ø 3.7 mm |

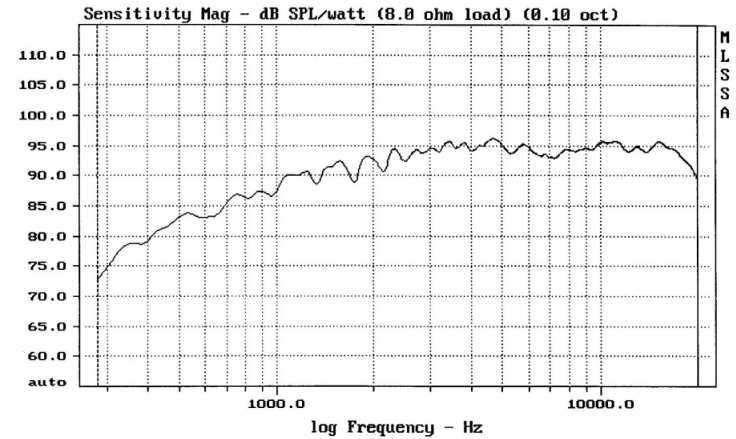
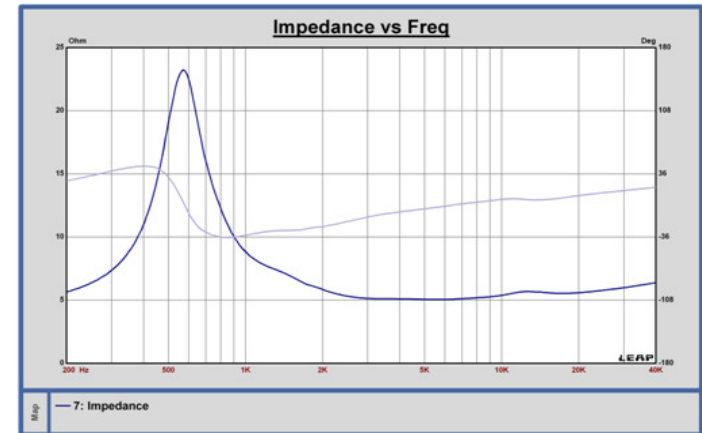

Driver is mounted rigidly in free air with no baffle or enclosure. Input signal is a stepped sinusoidal at 1VRMS. Impedance is measured using constant-voltage method. No smoothing was applied.

Driver is mounted rigidly on an IEC baffle. Microphone distance is 0.5m, input voltage 2.83VRMS and normalized to 1m. 1/12 octave smoothing was applied.

*Morel operates a policy of continuous product design improvement, consequently specifications are subject to alteration without prior notice.