



# CAT 408

## Classic Advanced, Tweeter

### Ø 72mm, 8Ω

#### SPECIFICATIONS

#### General Data

Overall Dimensions	<b>DxH</b>	72mm(2.83)x60mm(2.3")
Nominal Power Handling (DIN)	<b>P</b>	120W
Transient Power 10ms		1000W
Sensitivity 1W/1M		89dB SPL
Frequency Response		1,600-25,000 Hz
Cone/Dome Material		Acuflex™ hand coated soft dome
Net Weight	<b>Kg</b>	0.09

#### Electrical Data

Nominal Impedance	<b>Z</b>	8Ω
DC Resistance	<b>Re</b>	5.2Ω
Voice Coil Inductance @ 1KHz	<b>LBM</b>	0.09mH

#### Voice Coil and Magnet Parameters

Voice Coil Diameter	<b>DIA</b>	28mm
Voice Coil Height		2.7mm
HE Magnetic Gap Height	<b>HE</b>	2.5mm
Max. Linear Excursion	<b>X</b>	
Voice Coil Former		Aluminum
Voice Coil Wire		Hexatech™ Aluminum
Number Of Layers		2
Magnet System Type		Neodymium vented
B Flux Density	<b>B</b>	
BL Product	<b>BXL</b>	

#### T-S Parameters

Suspension Compliance	<b>Cms</b>		
Mechanical Q Factor	<b>Qms</b>	0.87	
Electrical Q Factor	<b>Qes</b>	1.3	
Total Q Factor	<b>Qts</b>	0.52	
Mechanical Resistance	<b>Rms</b>		
Moving Mass	<b>Mms</b>	0.46 g	
Eq. Cas Air Load (liters)	<b>VAS</b>		
Resonant Frequency	<b>Fs</b>	780 Hz	
Effective Piston Area	<b>SD</b>	6.0 cm <sup>2</sup>	

#### Features

- \* 72mm compact face plate
- \* Large Hexatech™ aluminum voice coil
- \* Neodymium magnet system
- \* Ferro fluid cooled
- \* High power handling

#### Unit Dimensions

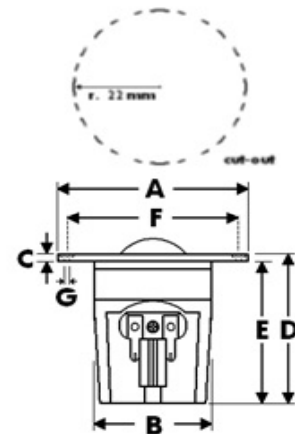

A - Overall diameter	72mm
B - Cut out diameter	44mm
C - Flange thickness	3mm
D - Overall height	60mm
E - Magnet/Chamber depth	57mm
F - Mounting holes location on rim	62mm
G - 3 Mounting holes, at 120° interval,	
inner hole diameter	Ø 3mm
pocket	h 1mm, Ø 7mm

