

Features:

- Plastic exponential horn.
- Compact size, flat front.
- 25 mm (1") throat.
- 45° x 45° nominal coverage.
- Stage monitors, side-fill and P.A. applications.

SPECIFICATIONS

Nominal coverage		
Horizontal	45	degrees
Vertical	45	degrees
Directivity		
Directivity factor (Q)	21	
Directivity index (Di)	13	dB
Sensitivity		
On driver, 1W @ 1m, on axis ¹	108	dB SPL
Frequency response @ -10 dB ²	800 to 18,000	Hz
Throat diameter	25 (1)	mm (in)
Minimum recommended crossover ³	600	Hz

¹ Measured with D210Ti driver, 1,200 - 5,000 Hz average.

² Measured with D210Ti driver.

³ With D210Ti driver.

ADDITIONAL INFORMATION

Horn material	PP plastic
Horn finish	Black/Silver/Onix
Overall dimensions	
Mouth height	156 (6.14) mm (in)
Mouth width	156 (6.14) mm (in)
Length	258 (10.16) mm (in)
Volume displaced by horn	1,1 (0.04) l (ft ³)
Net weight	210 (0.46) g (lb)
Gross weight	360 (0.79) g (lb)
Carton dimensions (W x D x H)	16 x 16 x 28 (6.3 x 6.3 x 11.0) cm (in)

MOUNTING INFORMATION

Mechanical connection of driver	Screw-on 1 3/8" - 18 TPI
Baffle cutout diameter (front mount)	140 (5.51) mm (in)

HORN x DRIVER CONNECTION

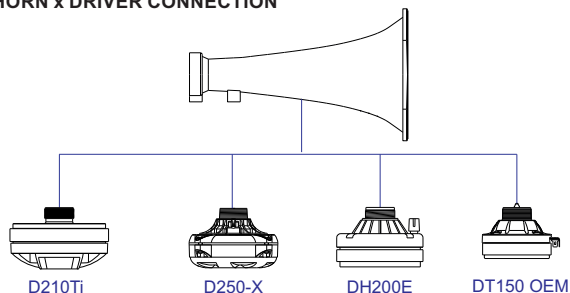

RESPONSE AND IMPEDANCE CURVES W/ D210Ti DRIVER INSIDE AN ANECHOIC CHAMBER, 1 W / 1 m

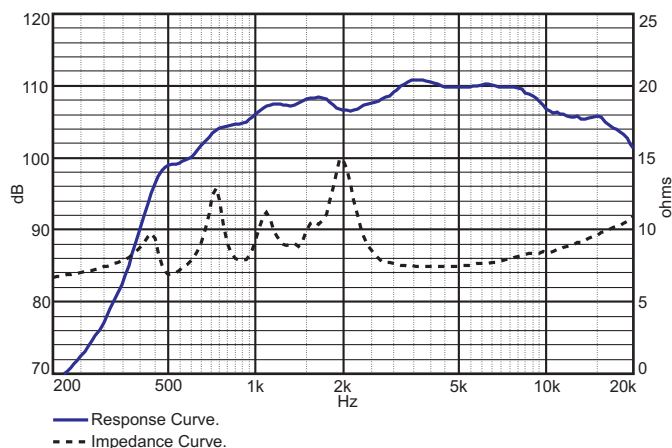

HL 14-25 BLACK



HL 14-25 SILVER



HL 14-25 AUTO ONIX



POLAR RESPONSE CURVES

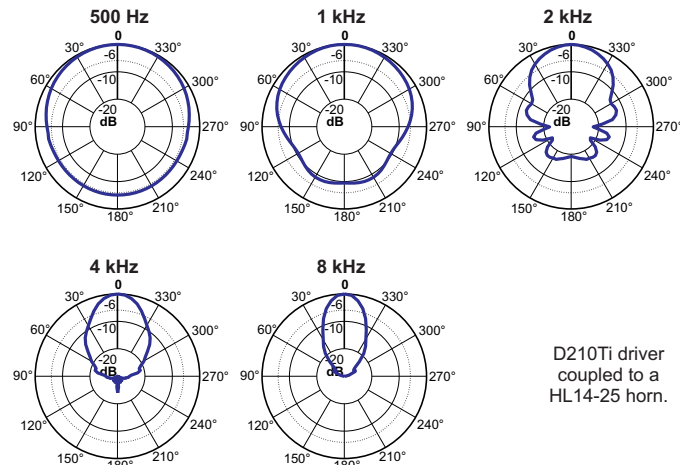

D210Ti driver coupled to a HL14-25 horn.

— Polar Response Curve.

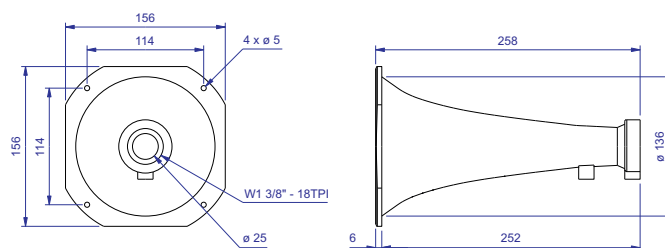

Dimensions in mm.

Specifications subject to change without prior notice.

Cod.: NA Rev.: 01 - 01/11

ELETRÔNICA SELENIUM S.A.
BR 386 Km 435 - Nova Santa Rita/RS - Brasil - CEP 92480-000
Tel.: 51. 3479 4000 Fax: 51. 3479 1150
www.selenium.com.br
Atendimento Técnico: 0800 514161

SELENIUM USA / SELENIUM EUROPE
www.seleniumloudspeakers.com
Toll Free: 1800 5620510